



METRO NORTH CROSSING OUTLOT

NW Barry Road & N. Wyandotte Street (NWC), Kansas City, MO



DEMOGRAPHICS

	1 mile	3 miles	5 miles
Estimated Population	7,837	68,117	157,297
Avg. Household Income	\$62,881	\$78,503	\$82,561

- First tier outlot development at main, lighted entrance of Metro North Crossing
- Approximately 1.4 acres available on the hard corner
- Next to the areas newest Dutch Bros. Coffee
- Adjacent to new Whataburger and Hawaiian Bros.
- Perfect for restaurant, retail, or medical
- One of the fastest growing areas in the metro with traffic counts of over 40,000 CPD
- Join KC's newest premier destination for entertainment, shopping and dining
- Contact agent for pricing



CLICK HERE TO VIEW MORE
LISTING INFORMATION

For More Information Contact:

MARK MCCONAHAY | 816.412.7386 | mmcconahay@blockandco.com

Exclusive Agent



METRO NORTH CROSSING OUTLOT

NW Barry Road & N. Wyandotte Street (NWC), Kansas City, MO

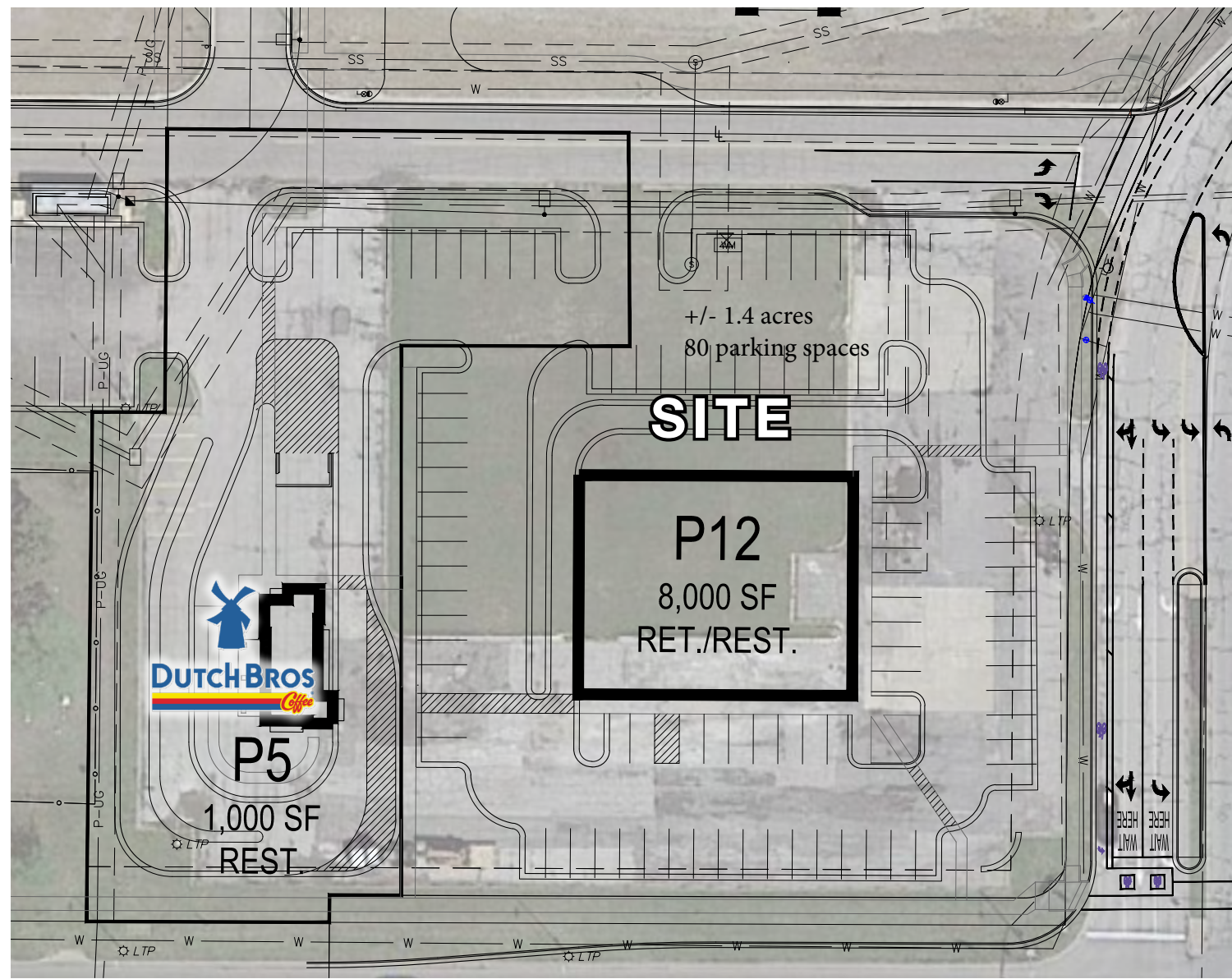



METRO NORTH CROSSING OUTLOT

NW Barry Road & N. Wyandotte Street (NWC), Kansas City, MO

PLAN

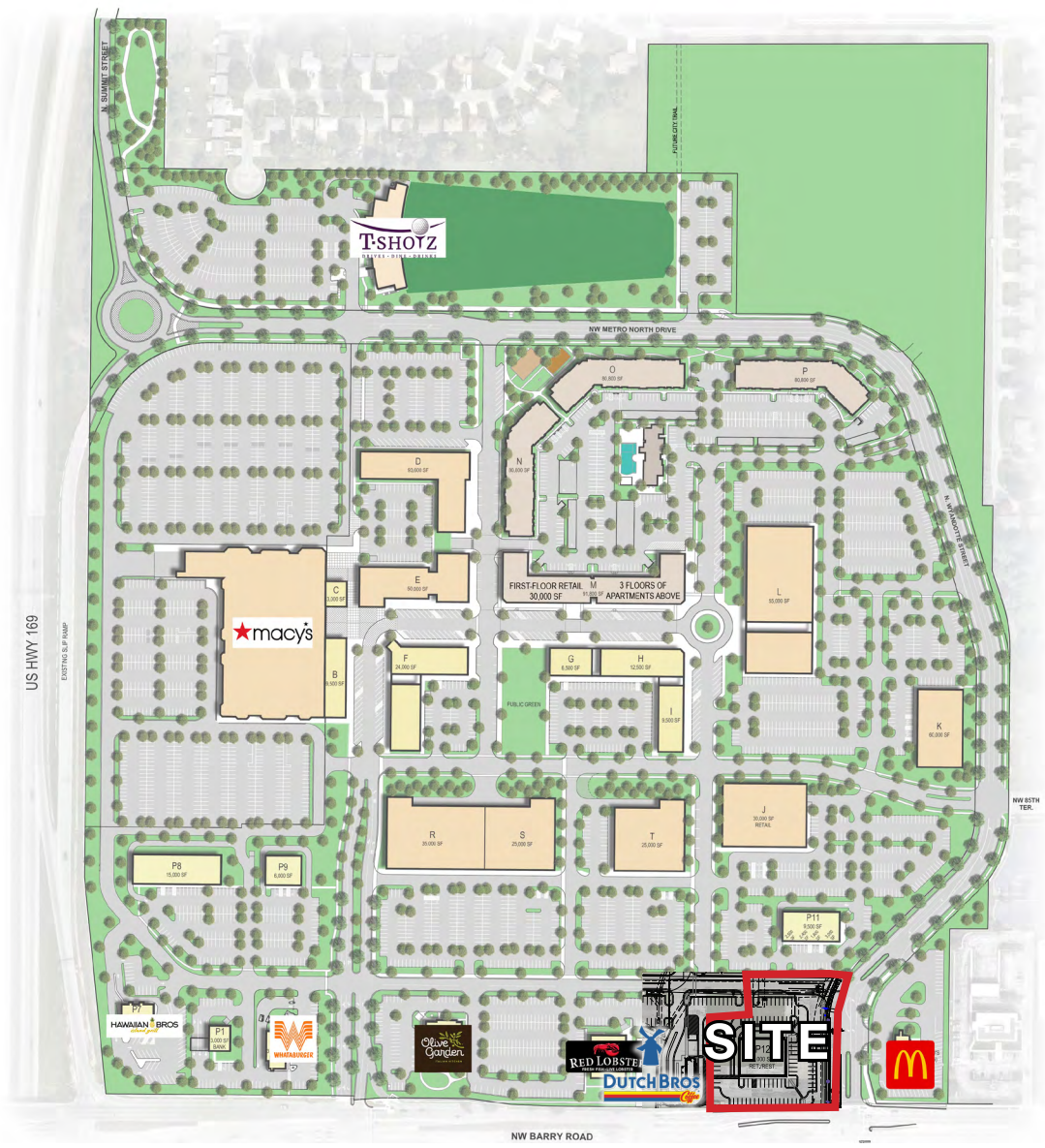



METRO NORTH CROSSING OUTLOT

NW Barry Road & N. Wyandotte Street (NWC), Kansas City, MO

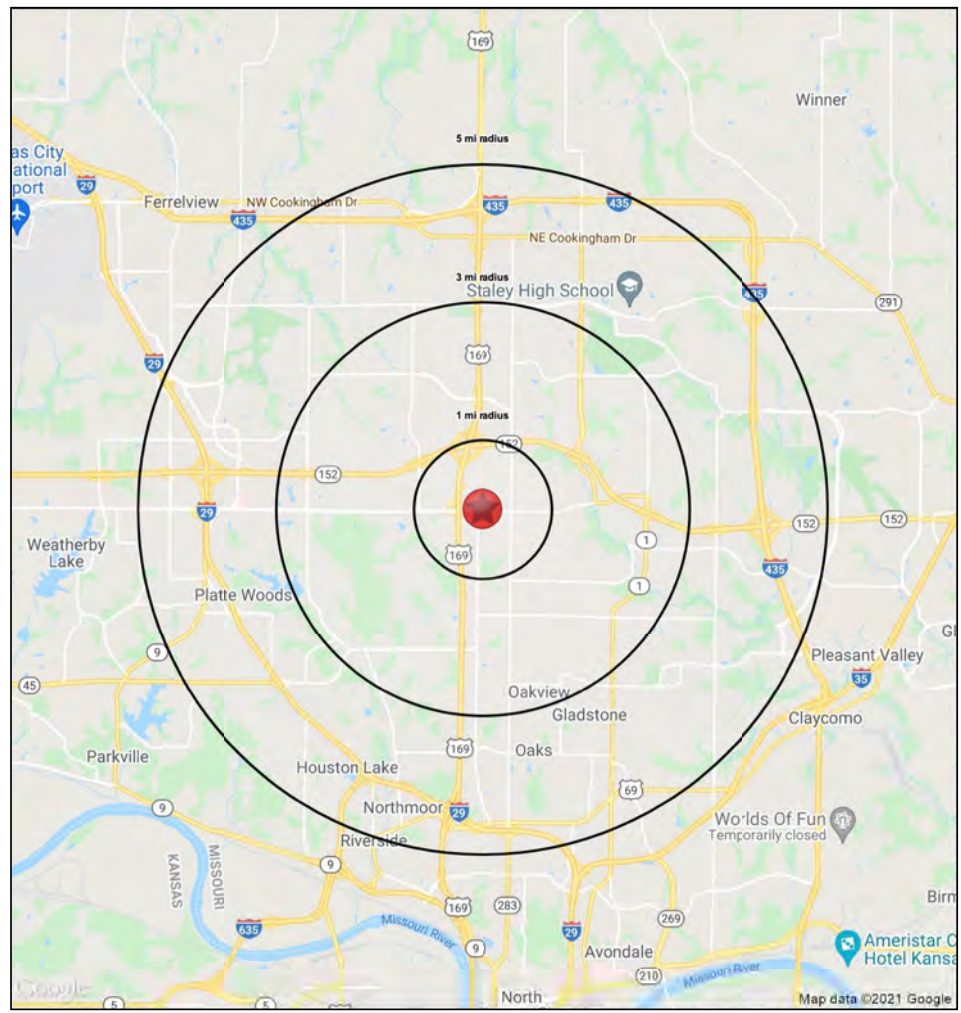
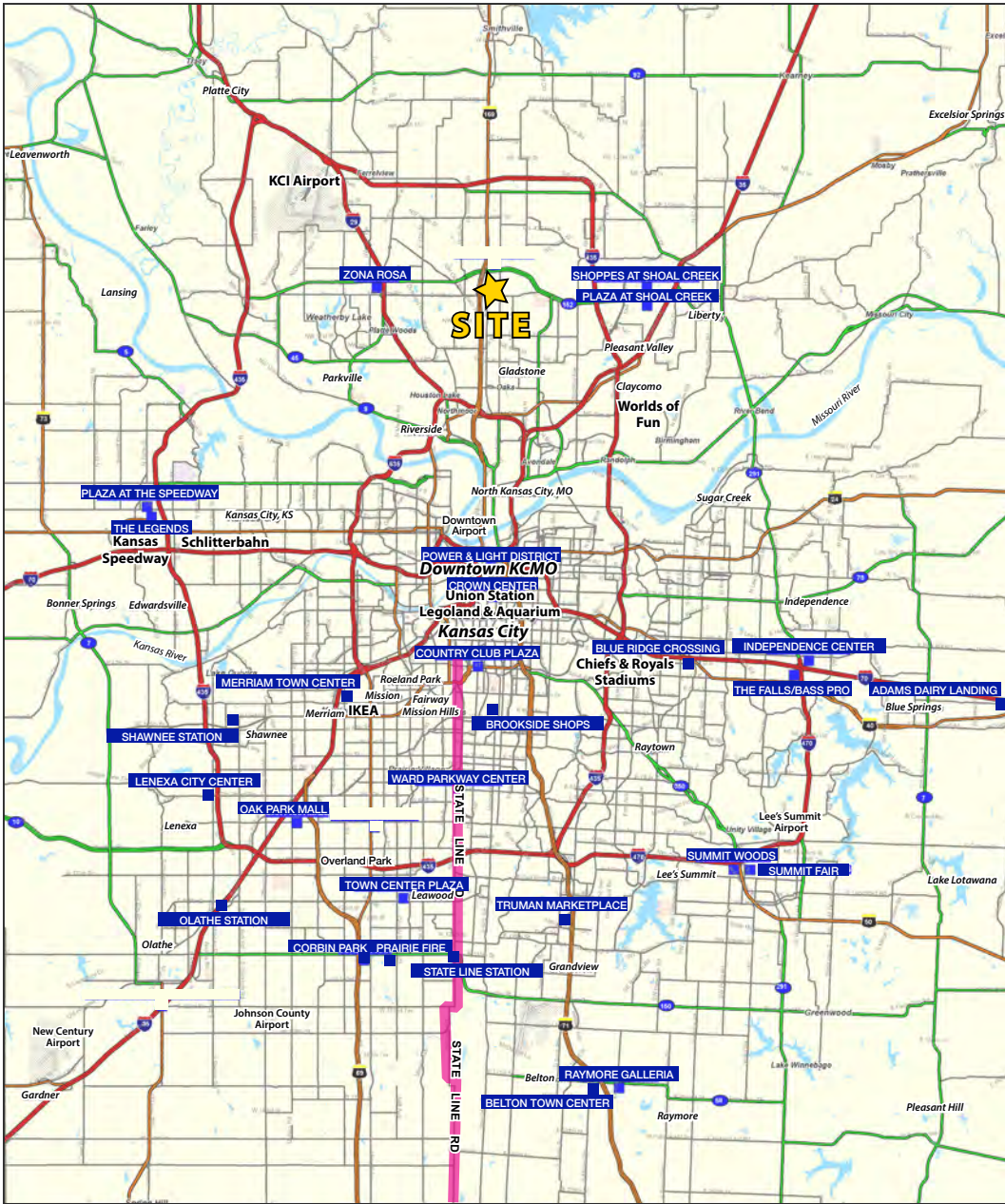



METRO NORTH CROSSING OUTLOT

NW Barry Road & N. Wyandotte Street (NWC), Kansas City, MO

NW Barry Rd & N. Wyandotte Street Kansas City, MO	1 mi radius	3 mi radius	5 mi radius
Population			
2022 Estimated Population	7,837	68,117	157,297
2027 Projected Population	8,032	72,373	168,681
2020 Census Population	7,711	67,526	153,981
2010 Census Population	7,540	57,781	129,655
Projected Annual Growth 2022 to 2027	0.5%	1.2%	1.4%
Historical Annual Growth 2010 to 2022	0.3%	1.5%	1.8%
2022 Median Age	34.6	37.3	37.9
Households			
2022 Estimated Households	3,443	28,219	64,808
2027 Projected Households	3,569	30,325	70,398
2020 Census Households	3,384	27,920	63,536
2010 Census Households	3,241	24,100	53,937
Projected Annual Growth 2022 to 2027	0.7%	1.5%	1.7%
Historical Annual Growth 2010 to 2022	0.5%	1.4%	1.7%
Race and Ethnicity			
2022 Estimated White	72.5%	74.4%	74.2%
2022 Estimated Black or African American	11.6%	10.0%	9.7%
2022 Estimated Asian or Pacific Islander	2.9%	3.2%	3.9%
2022 Estimated American Indian or Native Alaskan	0.5%	0.5%	0.5%
2022 Estimated Other Races	12.6%	11.9%	11.7%
2022 Estimated Hispanic	9.4%	8.5%	8.5%
Income			
2022 Estimated Average Household Income	\$62,881	\$78,503	\$82,561
2022 Estimated Median Household Income	\$65,873	\$76,577	\$77,776
2022 Estimated Per Capita Income	\$27,641	\$32,554	\$34,054
Education (Age 25+)			
2022 Estimated Elementary (Grade Level 0 to 8)	3.4%	1.3%	1.5%
2022 Estimated Some High School (Grade Level 9 to 11)	5.6%	4.4%	4.2%
2022 Estimated High School Graduate	25.9%	24.7%	24.6%
2022 Estimated Some College	30.0%	24.4%	23.4%
2022 Estimated Associates Degree Only	7.7%	8.7%	8.6%
2022 Estimated Bachelors Degree Only	18.0%	23.4%	23.9%
2022 Estimated Graduate Degree	9.5%	13.0%	13.8%
Business			
2022 Estimated Total Businesses	282	1,318	3,880
2022 Estimated Total Employees	3,326	12,453	37,098
2022 Estimated Employee Population per Business	11.8	9.5	9.6
2022 Estimated Residential Population per Business	27.8	51.7	40.5

©2022, Sites USA, Chandler, Arizona, 480-491-1112 Demographic Source: Applied Geographic Solutions 6/2022, TIGER Geography - RS1